

240 l/min	Supape de presiune Dn10,20,32	Fc -9
315 bar		

GENERALITATI

Supape de presiune pilotate cu sau fara supapa de ocolire incorporata.
 Scheme functionale diverse, conform tabelului 2.
 Reglaj manual cu roata de mana sau cap gradat cu sau fara asigurare .
 Suprafete de montaj pe placa conform -ISO 5781

CARACTERISTICI TEHNICE

GENERALE

Pozitia de montaj : indiferenta
 Sensul de curgere : B-A pentru supapele de reductie
 A-B pentru celelalte supape
 Temperatura mediului ambiant : -20°c.....+50°c

HIDRAULICE

Presiune nominala : 315 bar
 Presiuni de reglaj, pr: 3...160; 7....315 bar
 Debit maxim Dn10 60l/min , Dn20 ... 120l/min , Dn32 240l/min

Fluid :

- Tipul fluidului : ulei mineral aditivat .
- Domeniul de vascozitate : 10 ...500cSt
- Domeniul de temperatura : -25°C.....+80°C
- Filtrare: > 25 um

ELECTRICE

Tipul curentului :	curent continuu(cc)	curent alternativ (CA)
Tensiune :	12V 24V	220V/50Hz
Abaterea admisa a tensiunii :	+10%	
Durata relativa de actionare :	Da100%	
Numar maxim de comutari pe ora :	3600	
Putere absorbita la 20 °C :		
	la anclansare :	35 W 120VA
	la mentinere :	35 W 40 VA
Racordare :	cupla electrica tip stecker , conform ISO 4400	
Protectie :	IP65 ; conform STAS 5325 (DIN 40050)	
Timp de raspuns al distribuitorului de comanda :		
	la anclansare :	20... 60 ms
	la dezancansare :	10 ... 60ms

Tabel 2

Cod	Simbol	Denumire	DN		
			10	20	32
04		Supapa de siguranta	●	●	●
04U		Supapa de siguranta cu supapa de ocolire	●	●	●
05		Supapa de deconectare	●	●	
06		Supapa de succesiune	●	●	●
06U		Supapa de succesiune cu supapa de ocolire	●	●	
06 ED		Supapa de succesiune cu cuplare electrica	●	●	●
06 EI		Supapa de succesiune cu decuplare electrica	●	●	●
07		Supapa de conectare	●	●	
07 U		Supapa de conectare cu supapa de ocolire	●	●	
16		Supapa de reductie	●	●	●
16 U		Supapa de reductie cu supapa de ocolire	●	●	●

CURBE CARACTERISTICE

Supape de siguranta si succesiune

1.1 Caracteristica presiune debit : $P_r = f(Q)$

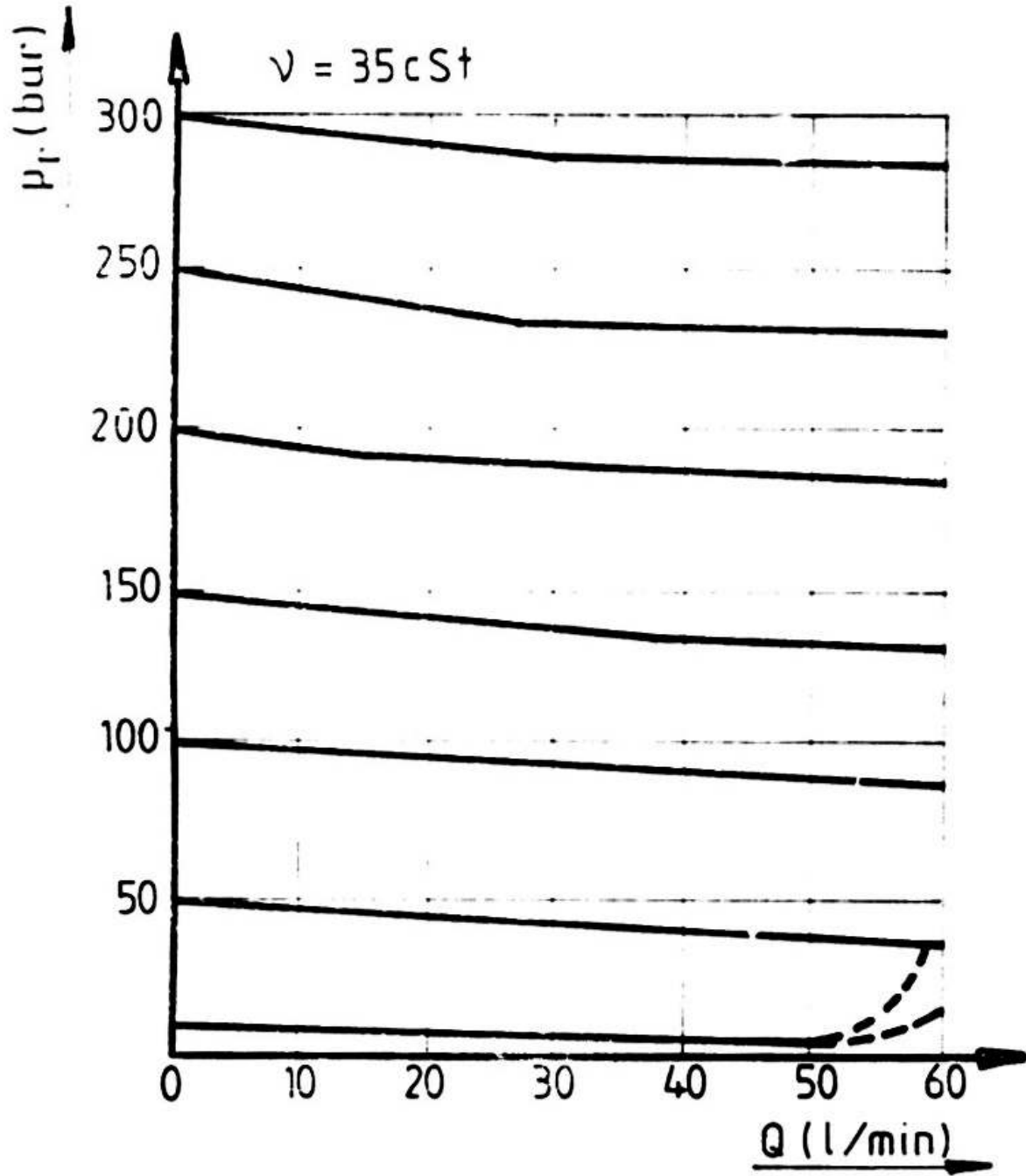

Fig. 1

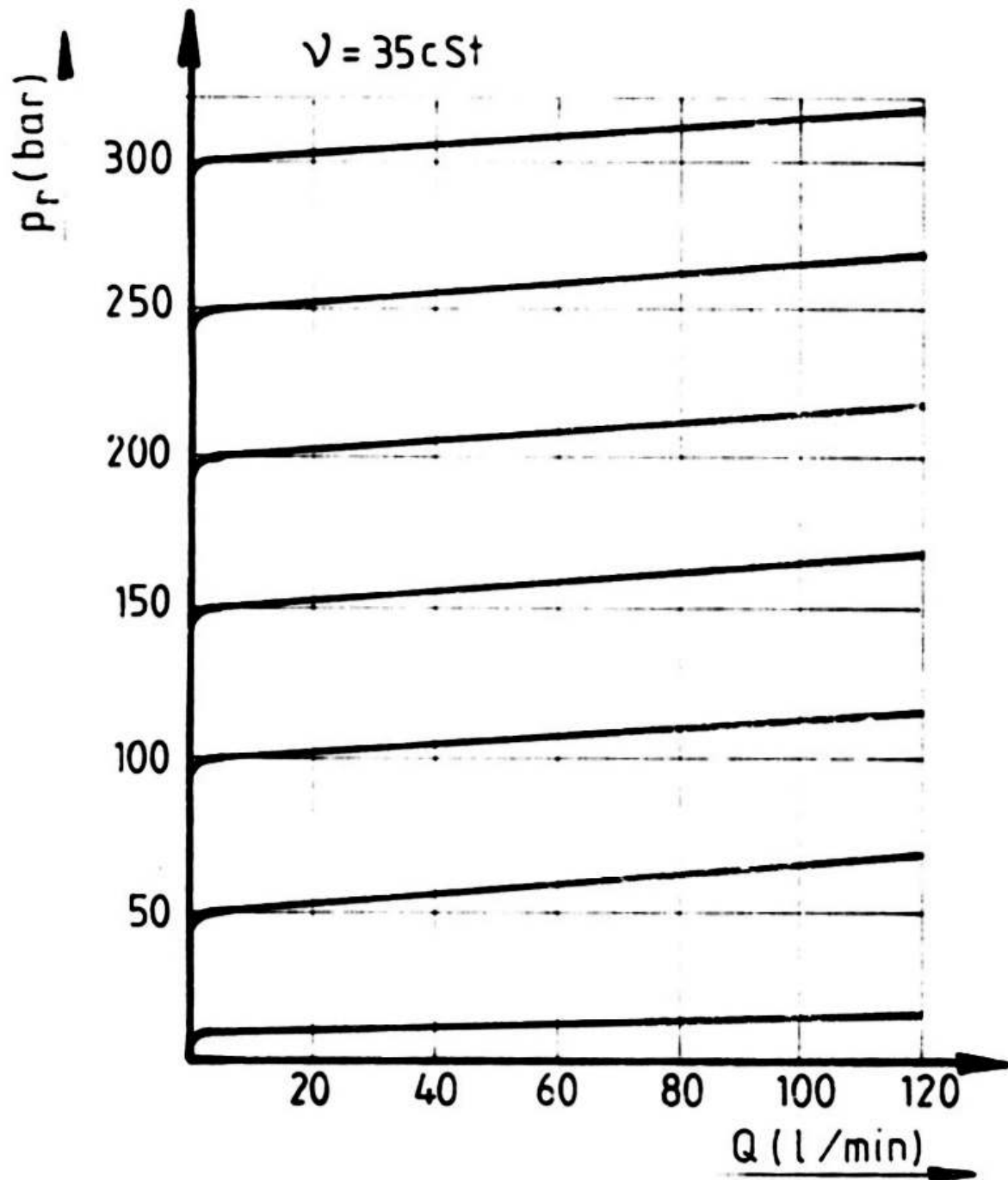

Fig. 2

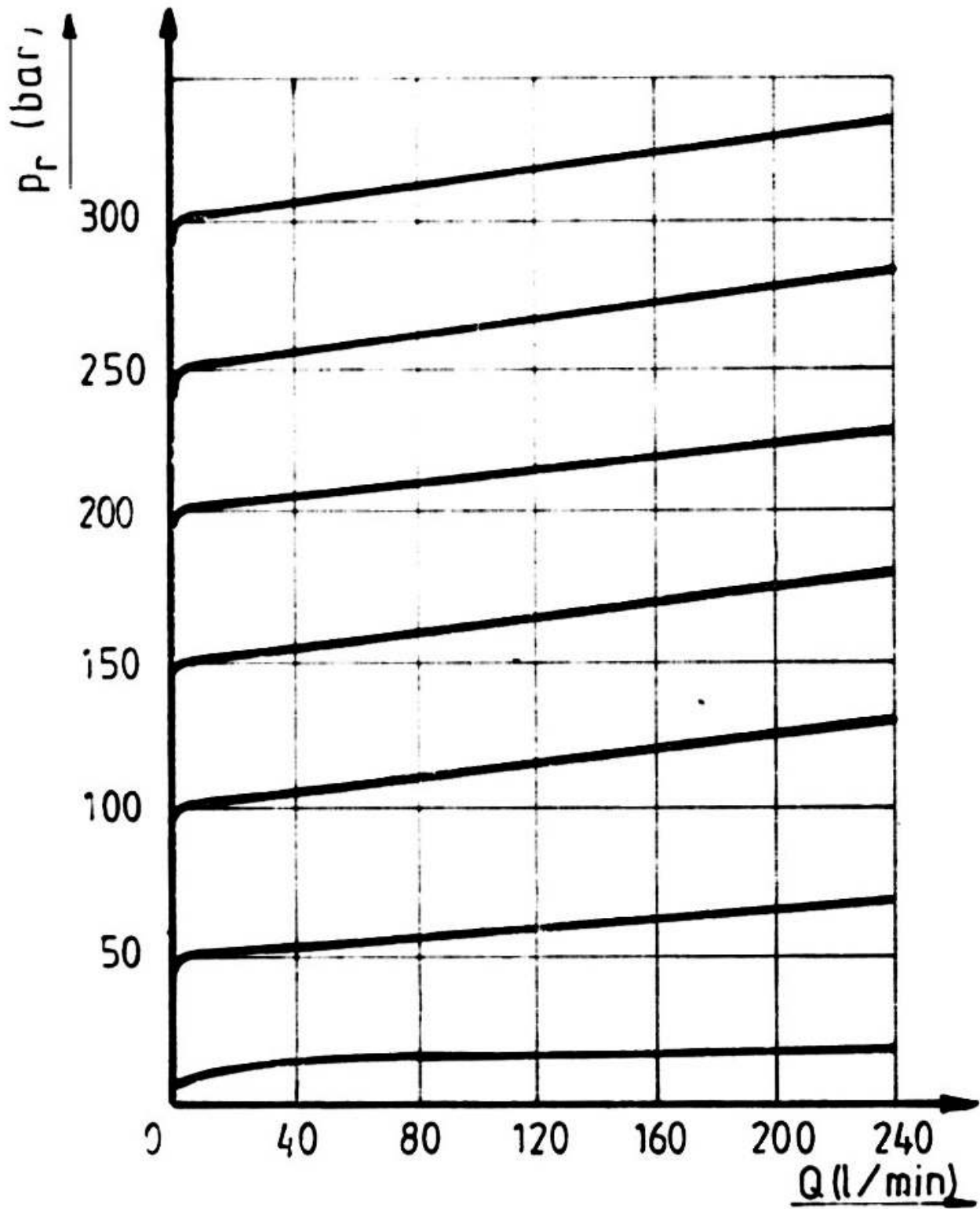

Fig. 3

1.2 Caderea de presiune prin supapa de ocolire $\Delta P_{B-A}=f(Q)$

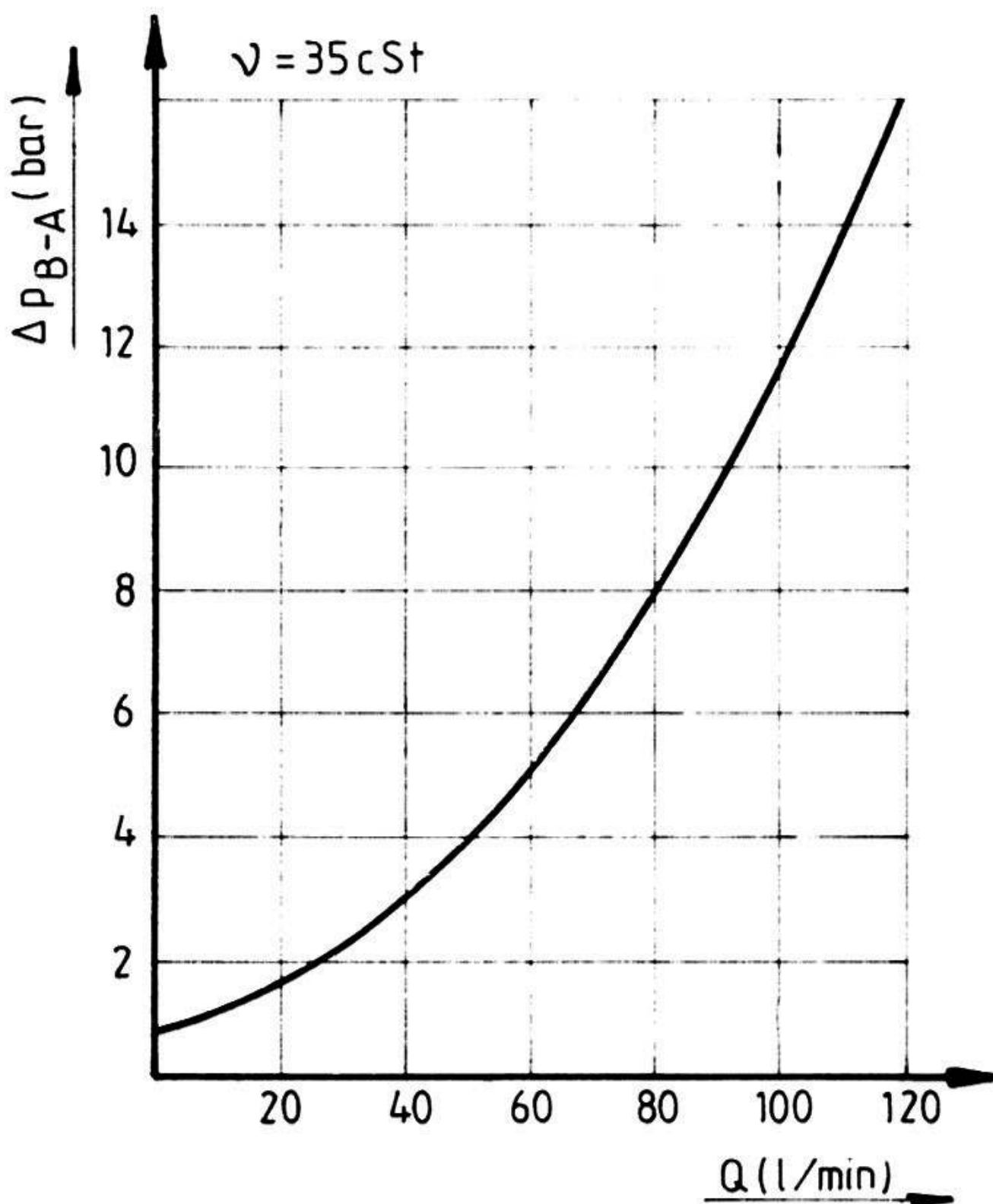

Fig. 4

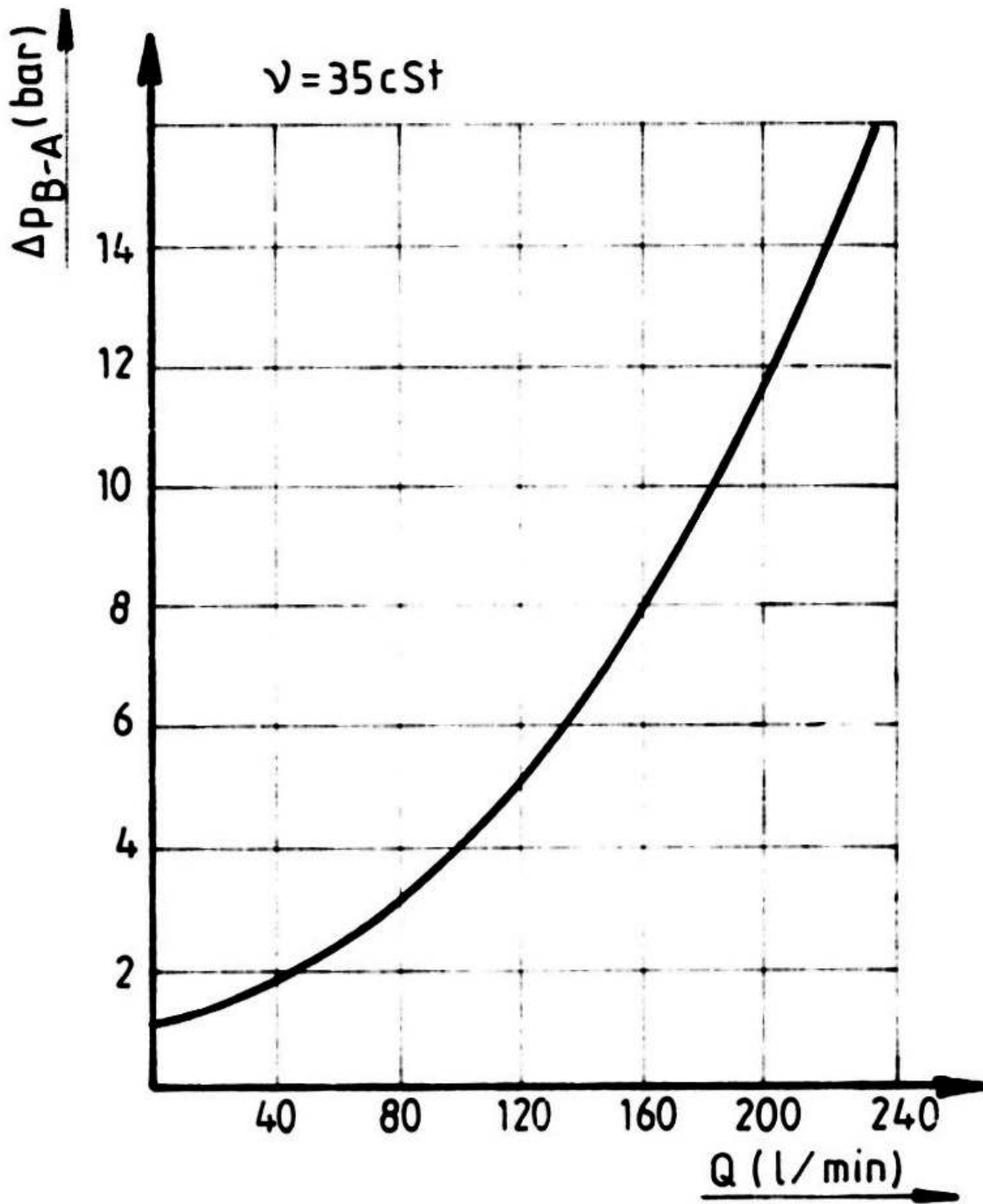

Fig. 5

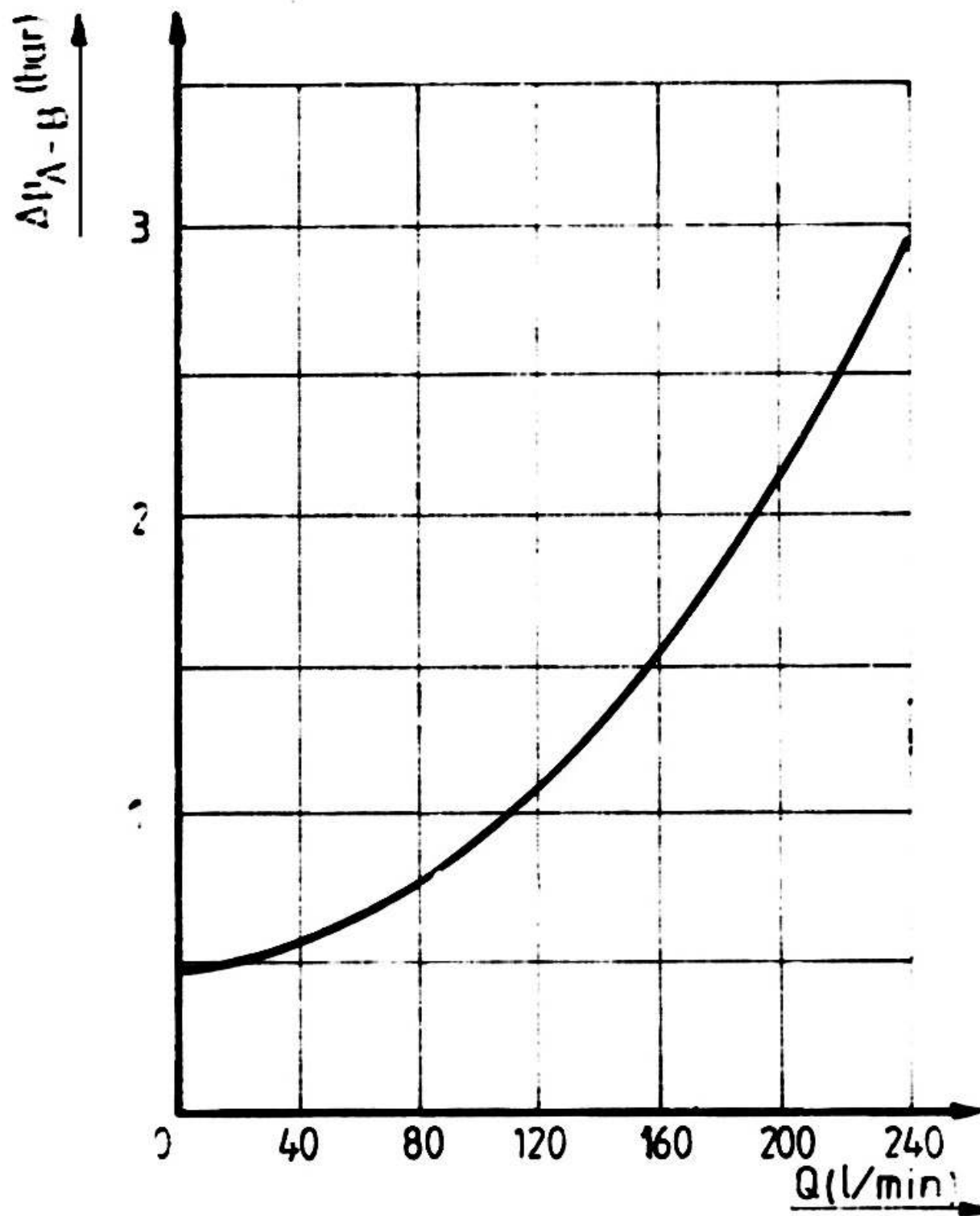

Fig. 6

1.3 Debitul de pilotare in functie de debitul deversat . $Q_p = f(Q)$

1.4 Caderea de presiune in functie de debit $\Delta p_{A-B} = f(Q)$ la supapele 06ED si 06EI , pe pozitia deschisa a distribuitorului de comanda .

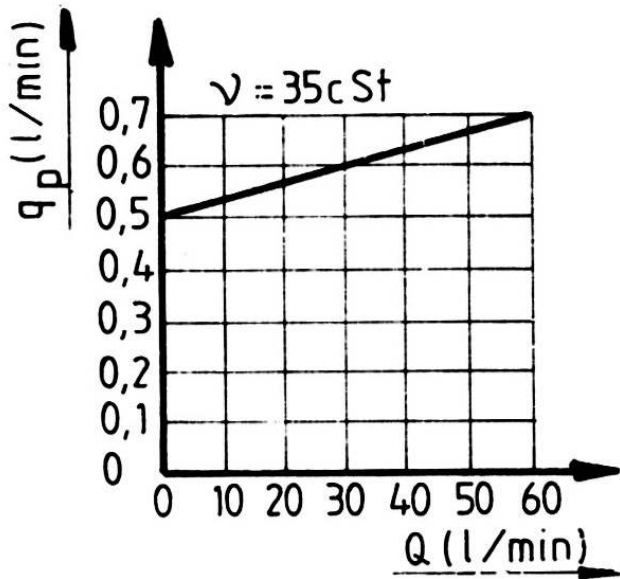

Fig. 7

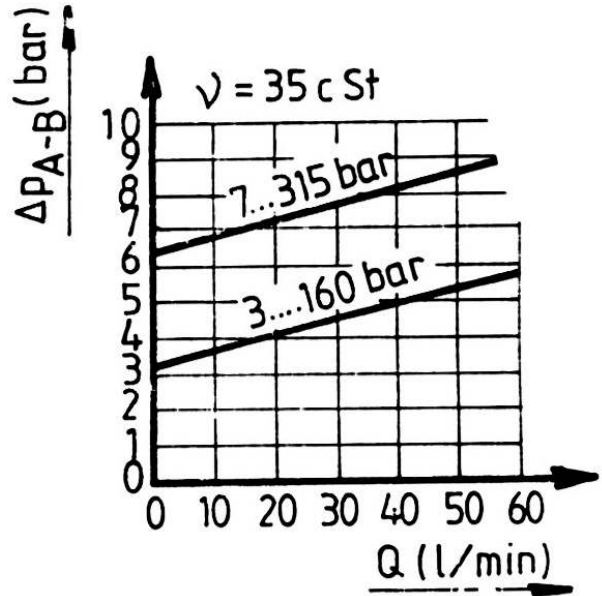

Fig. 10

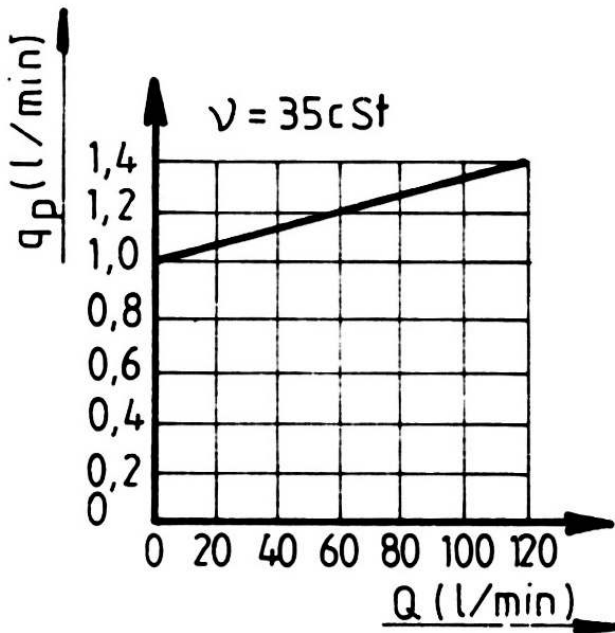

Fig. 8

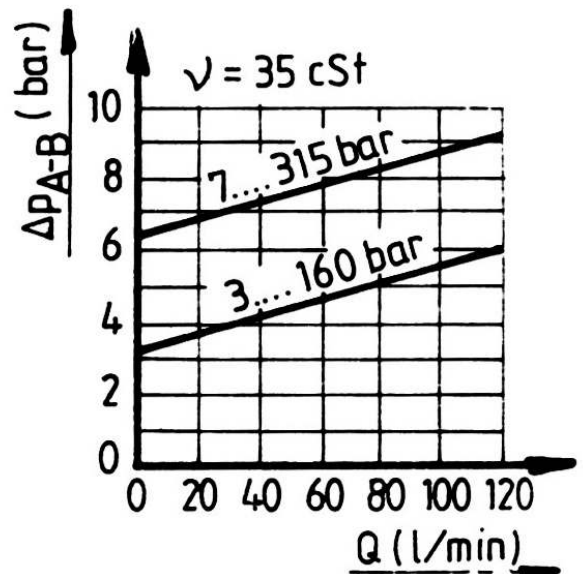

Fig. 11

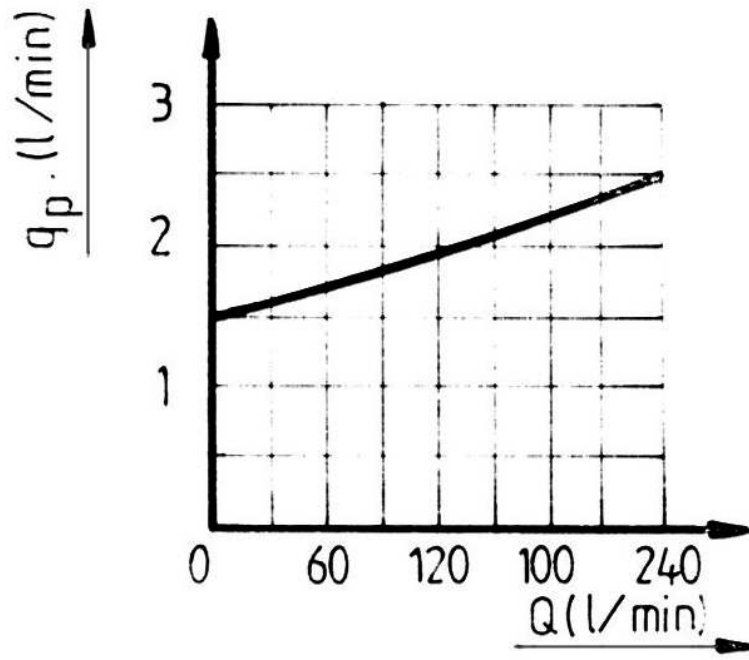

Fig. 9

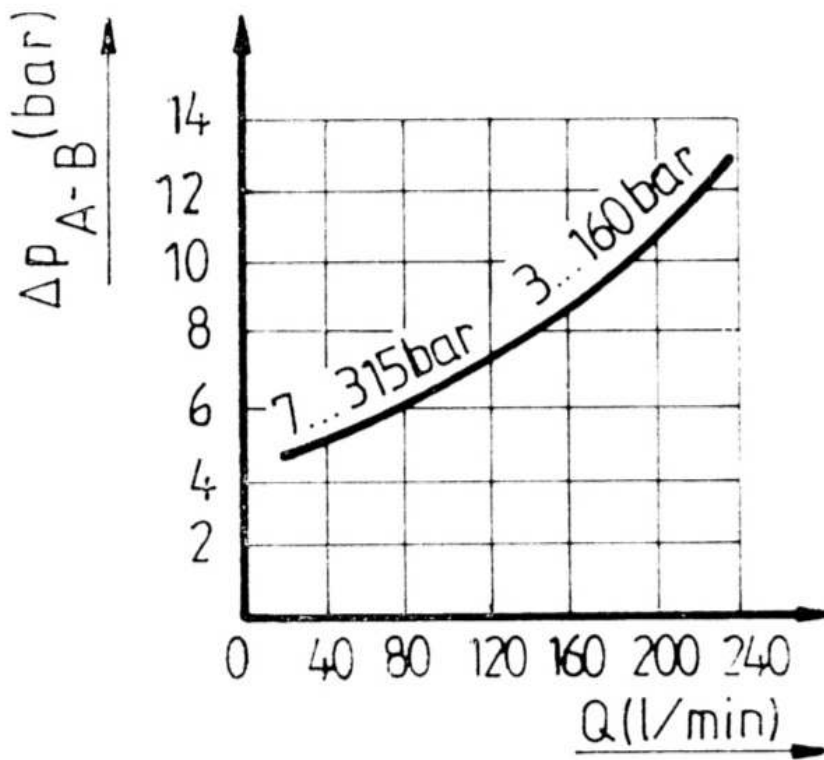

Fig. 12

SUPAPE DE REDUCTIE

2.1 Caracteristica presiune-debit $p_r = f(Q)$

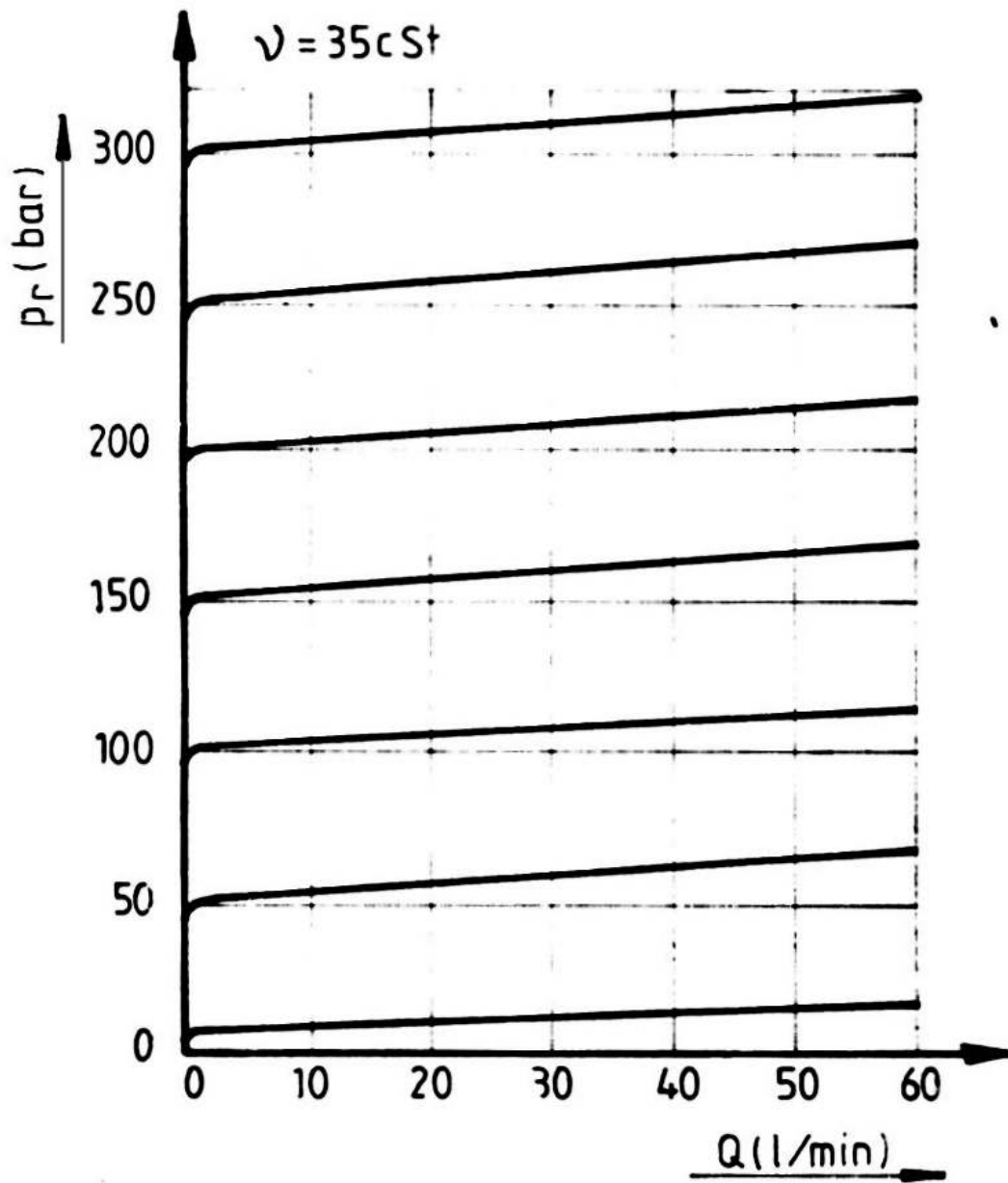

Fig. 13

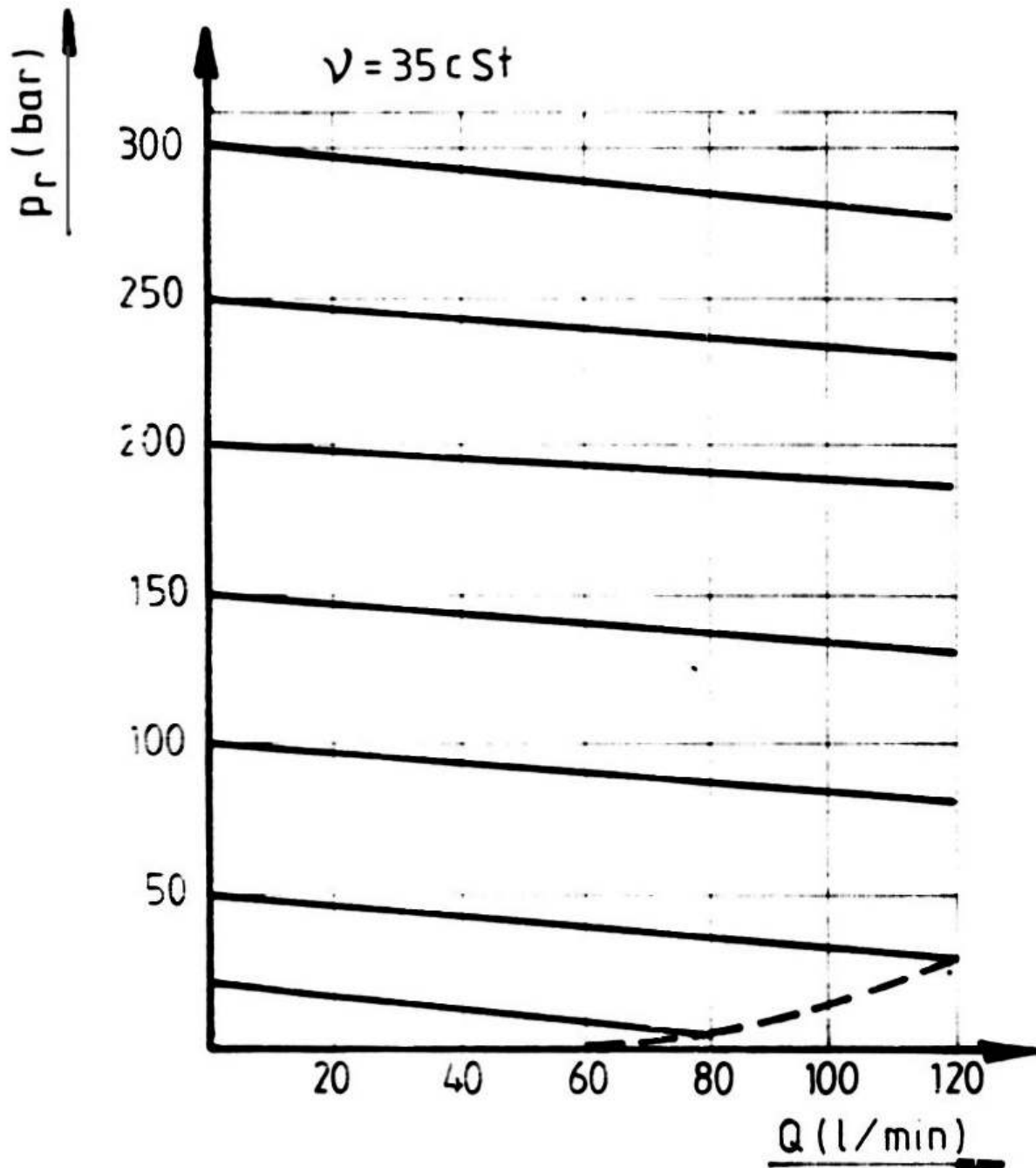

Fig. 14

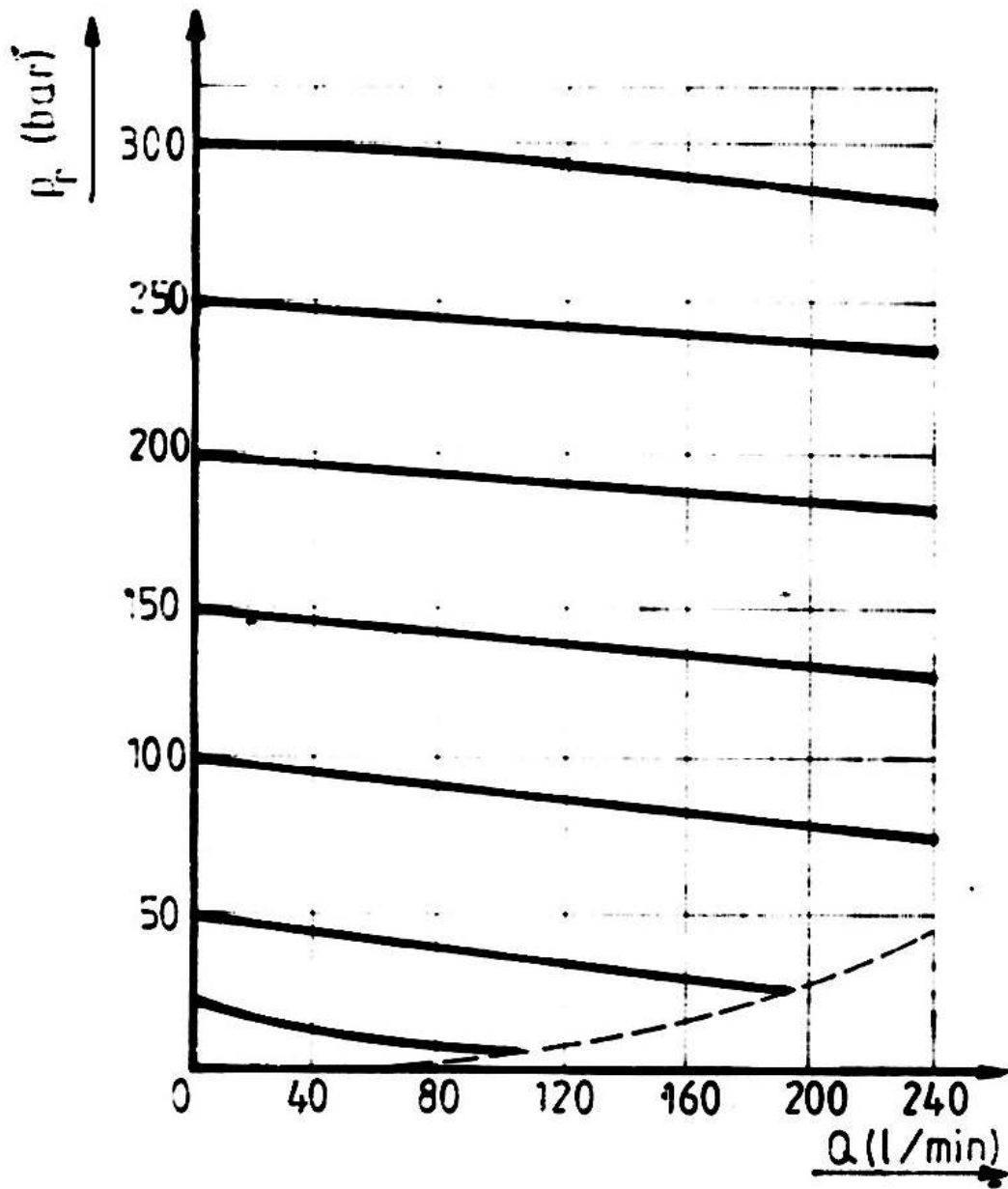

Fig. 15

2.2 Caderea de presiune prin supapa de ocolire $\Delta p_{A-B}=f(Q)$

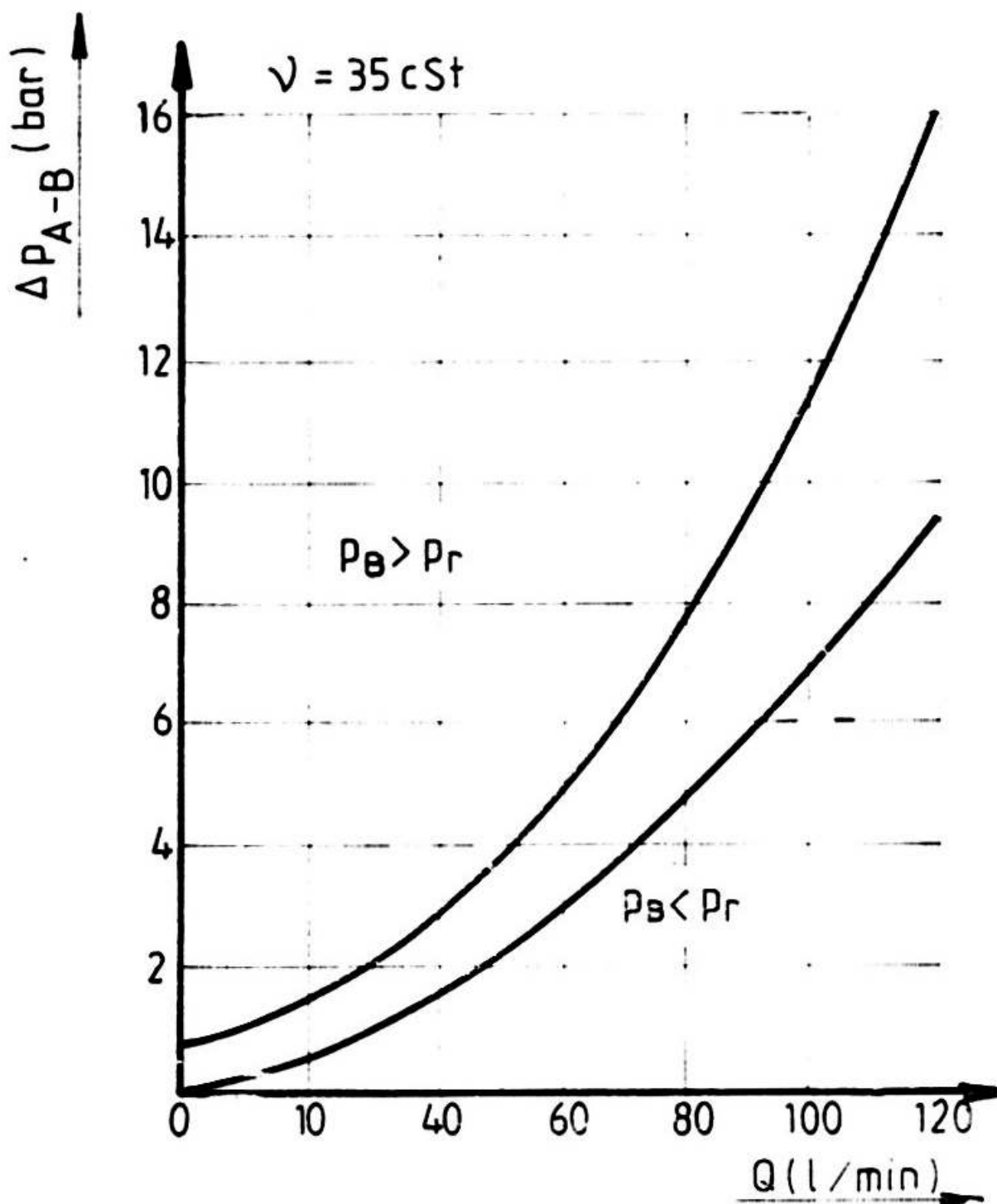

Fig. 16

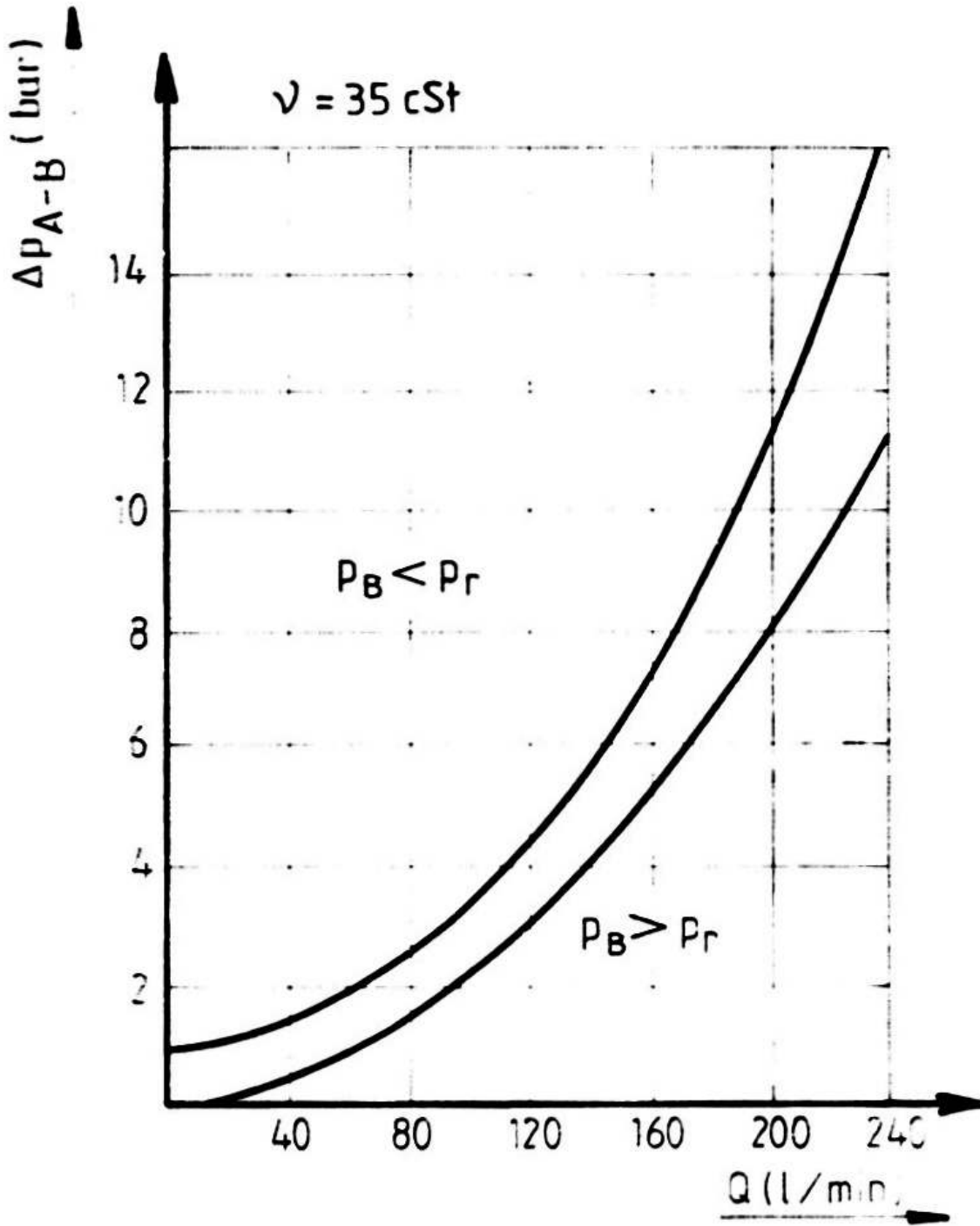

Fig. 17

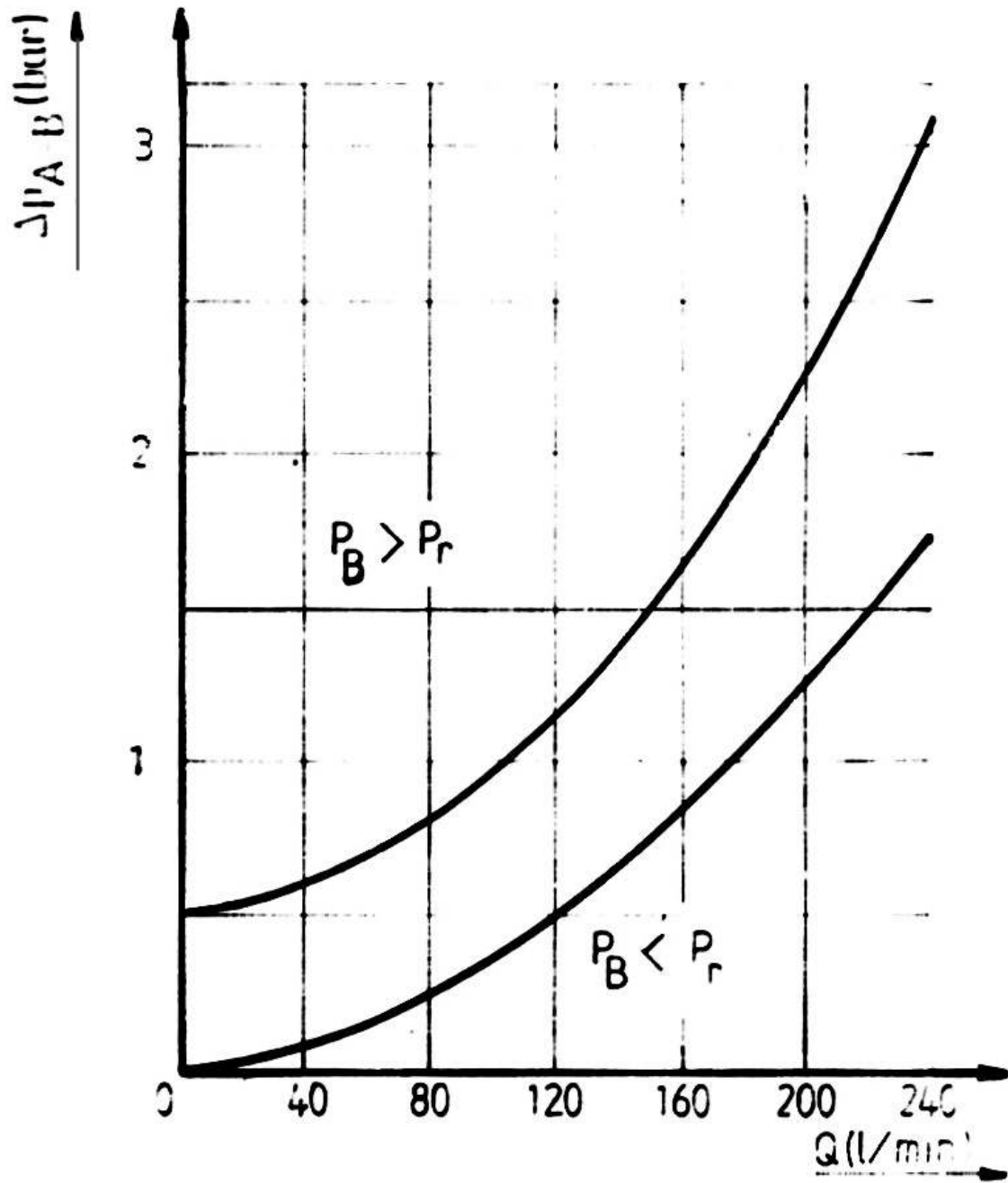

Fig. 18

2.3 Debitul de pilotare in functie de debitul deversat $q_p = f(Q)$

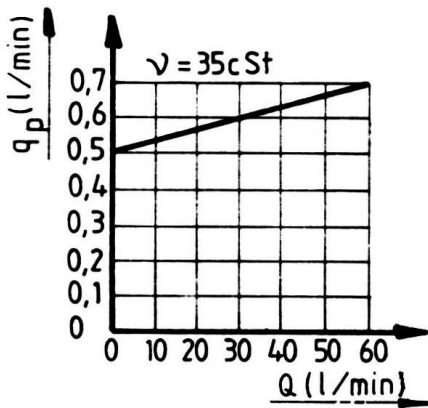

Fig. 19

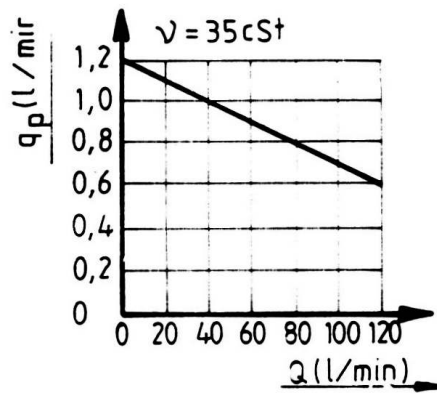

Fig. 20

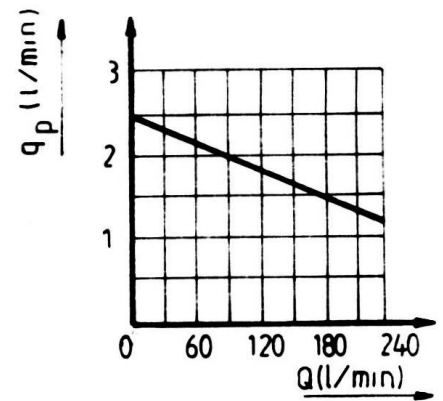

Fig. 21

3. SUPAPE DE DECONECTARE SI DE CONECTARE

3.1 Caderea de presiune in functie de debit $\Delta p_{A-B} = f(Q)$ in pozitie deschisa

3.2 Caderea de presiune prin supapa de ocolire $\Delta p_{B-A} = F(Q)$

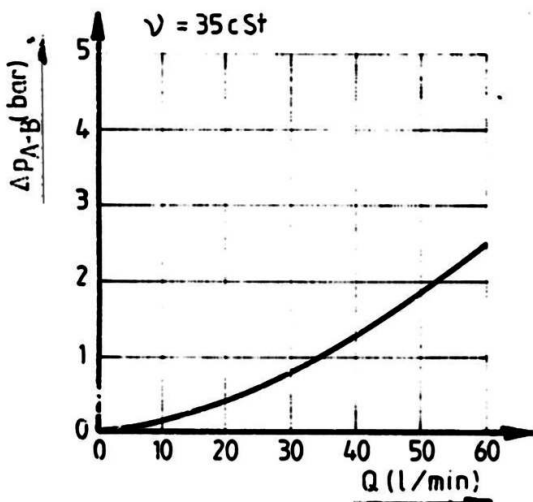

Fig. 22

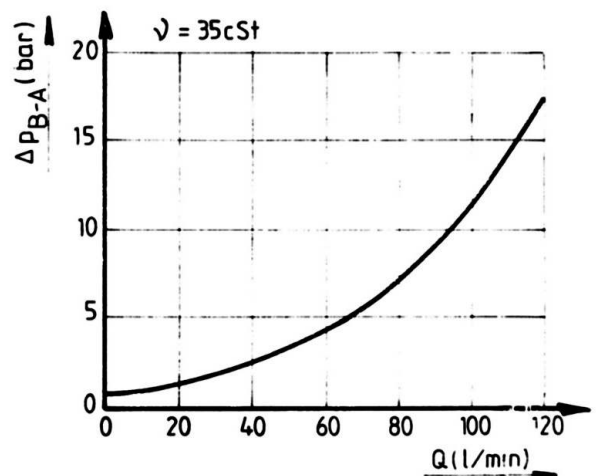

Fig. 24

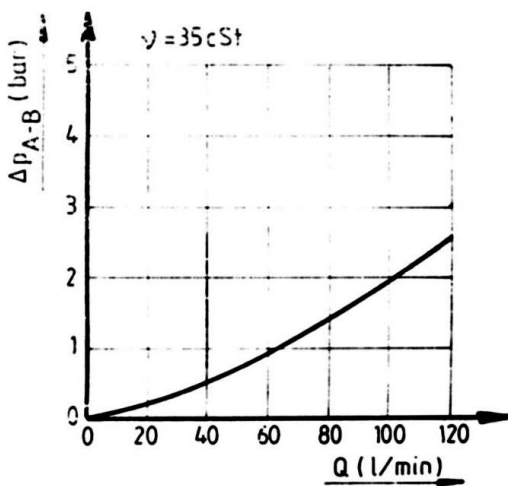

Fig. 23

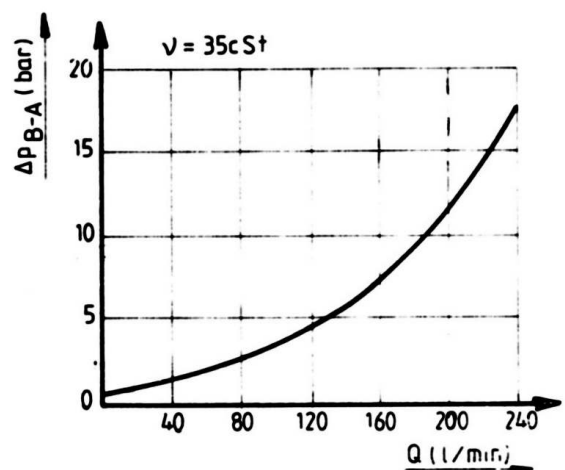

Fig. 25

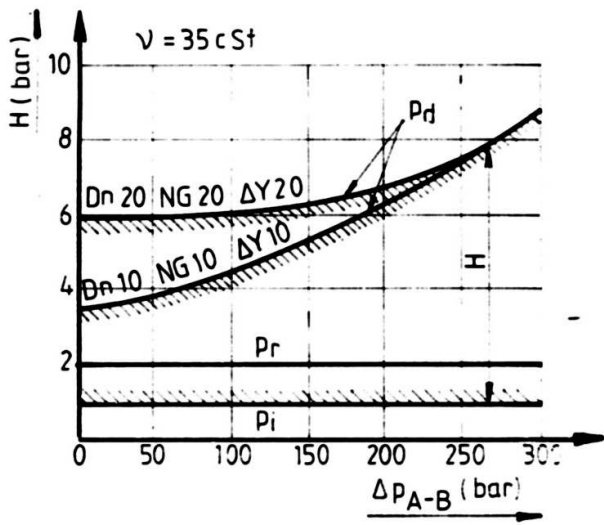

Fig. 26

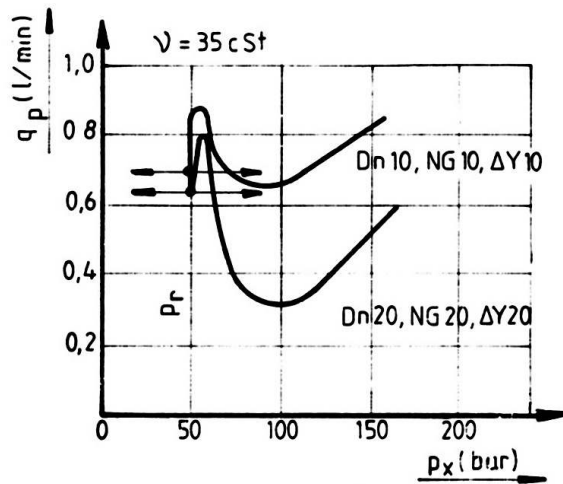

Fig. 27

DIMENSIUNI

Supape de presiune Dn10 Schemele 04 ,05, 06, 07 si 16

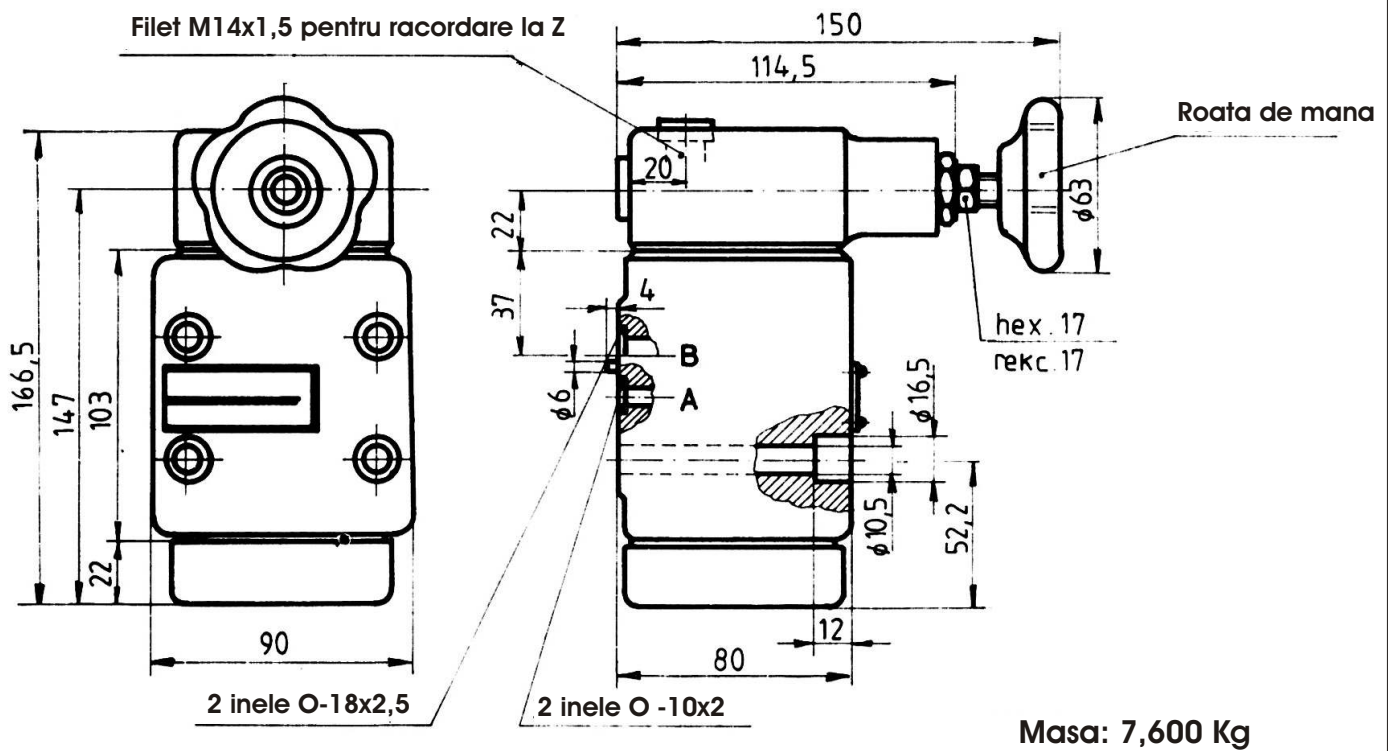

Fig. 28

Schemele 04U , 06U ,07U si 16 U

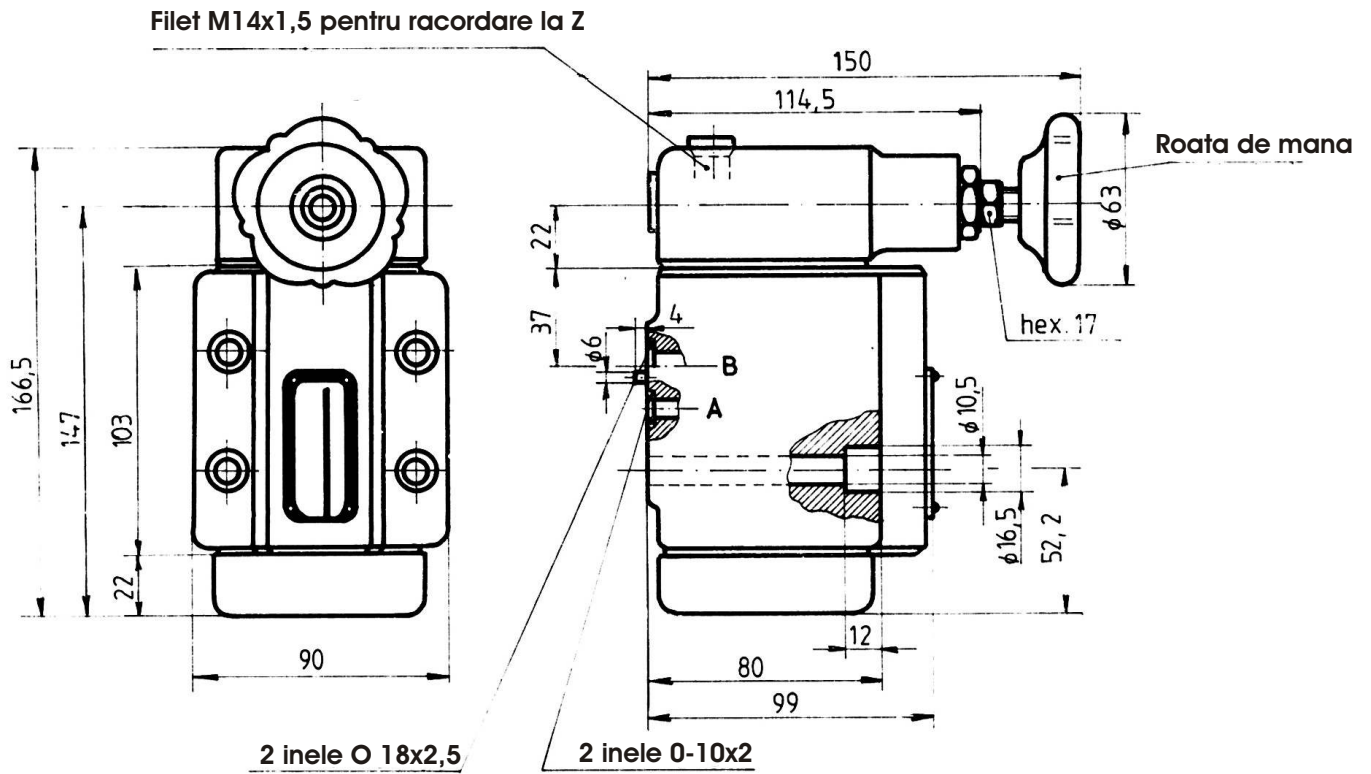

Fig. 29

Masa : 8.000 kg

Schemele 06 ED si 06 EL

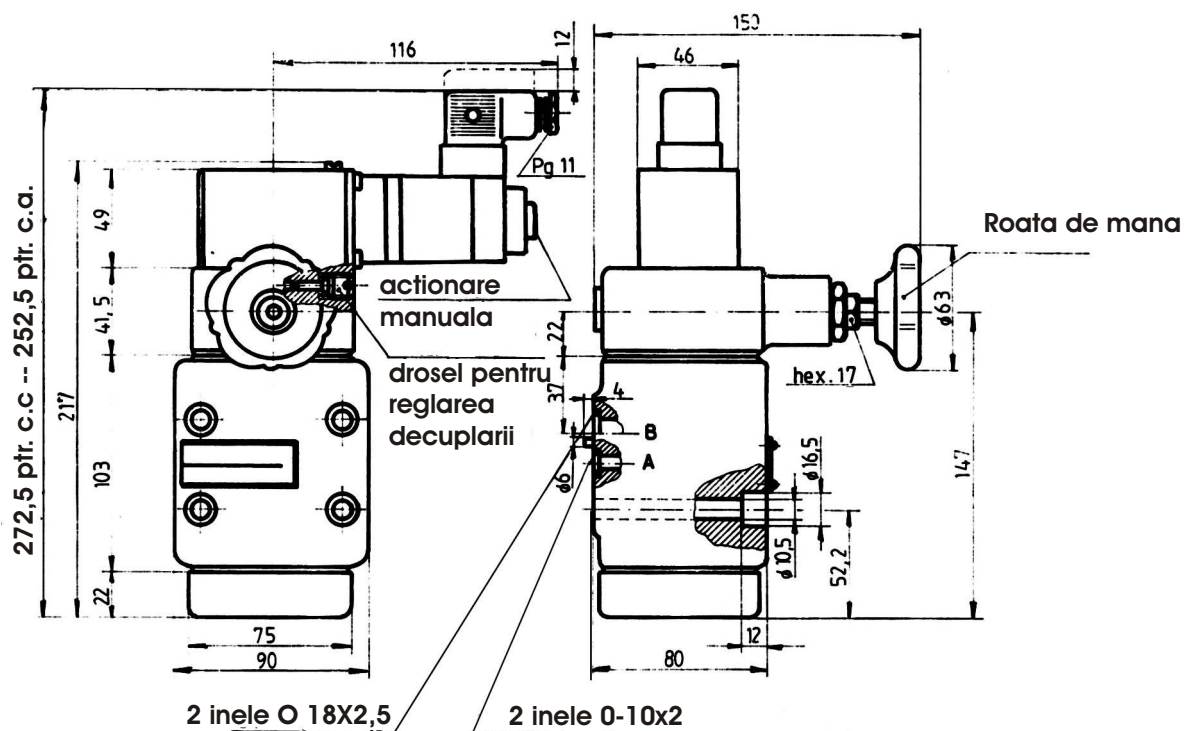

Fig. 30

Masa 9300 kg

SUPAPE DE PRESIUNE Dn20
Schemele 04, 05, 06, 07 si 16

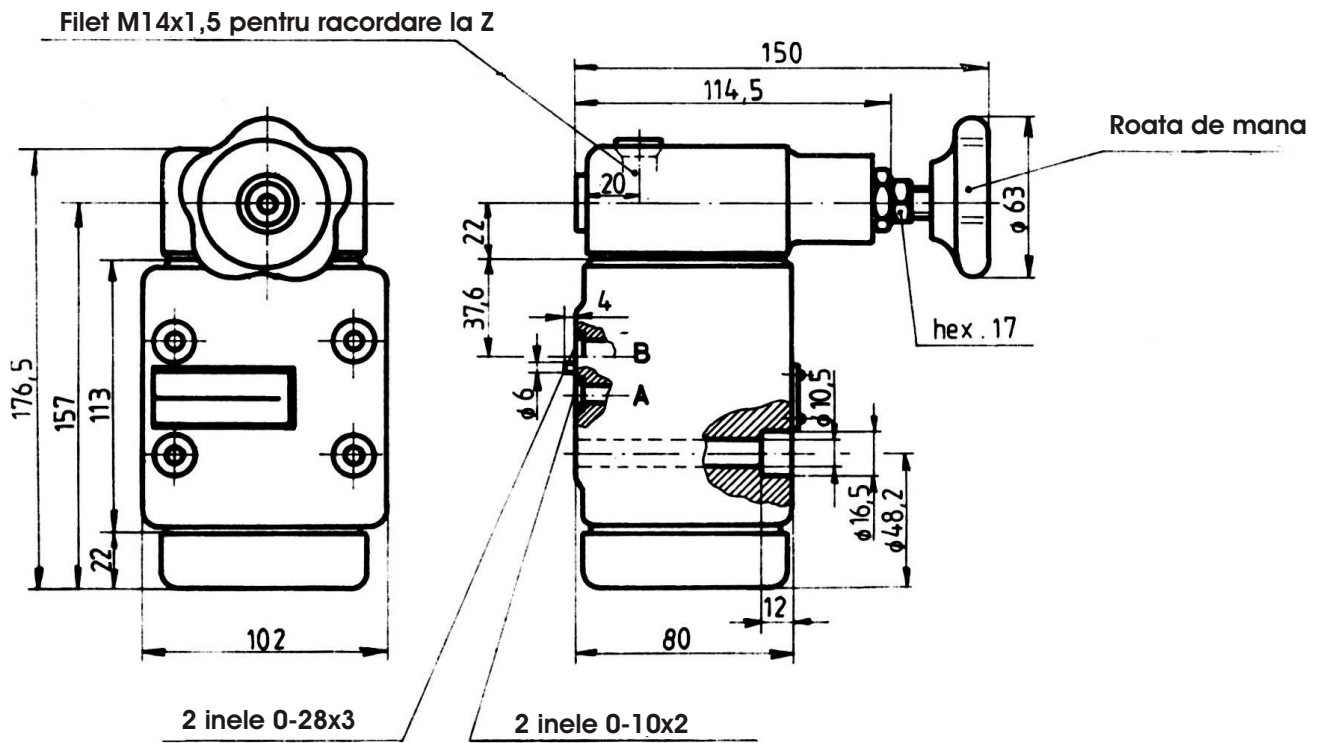

Fig. 31

Masa 8500kg

Schemele 04U, 06U, 07U SI 16U

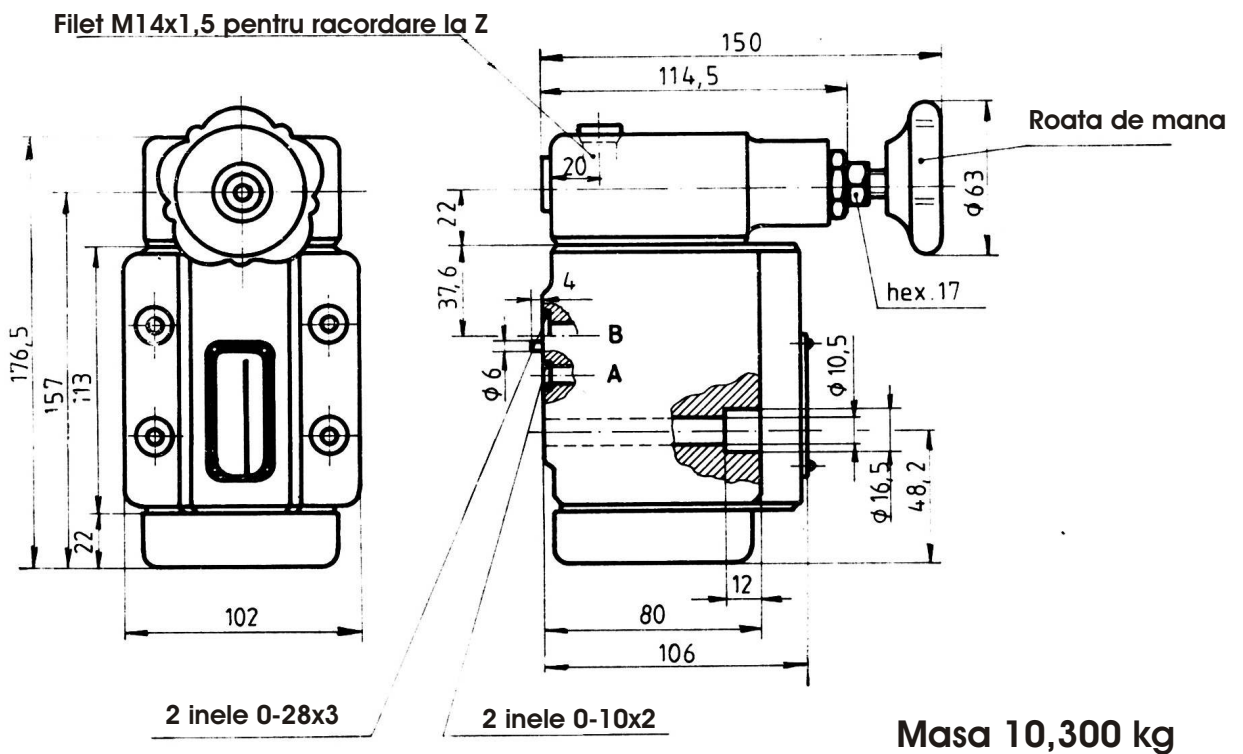

Fig. 32

Masa 10,300 kg

Schemele 06 ED si 06 EL

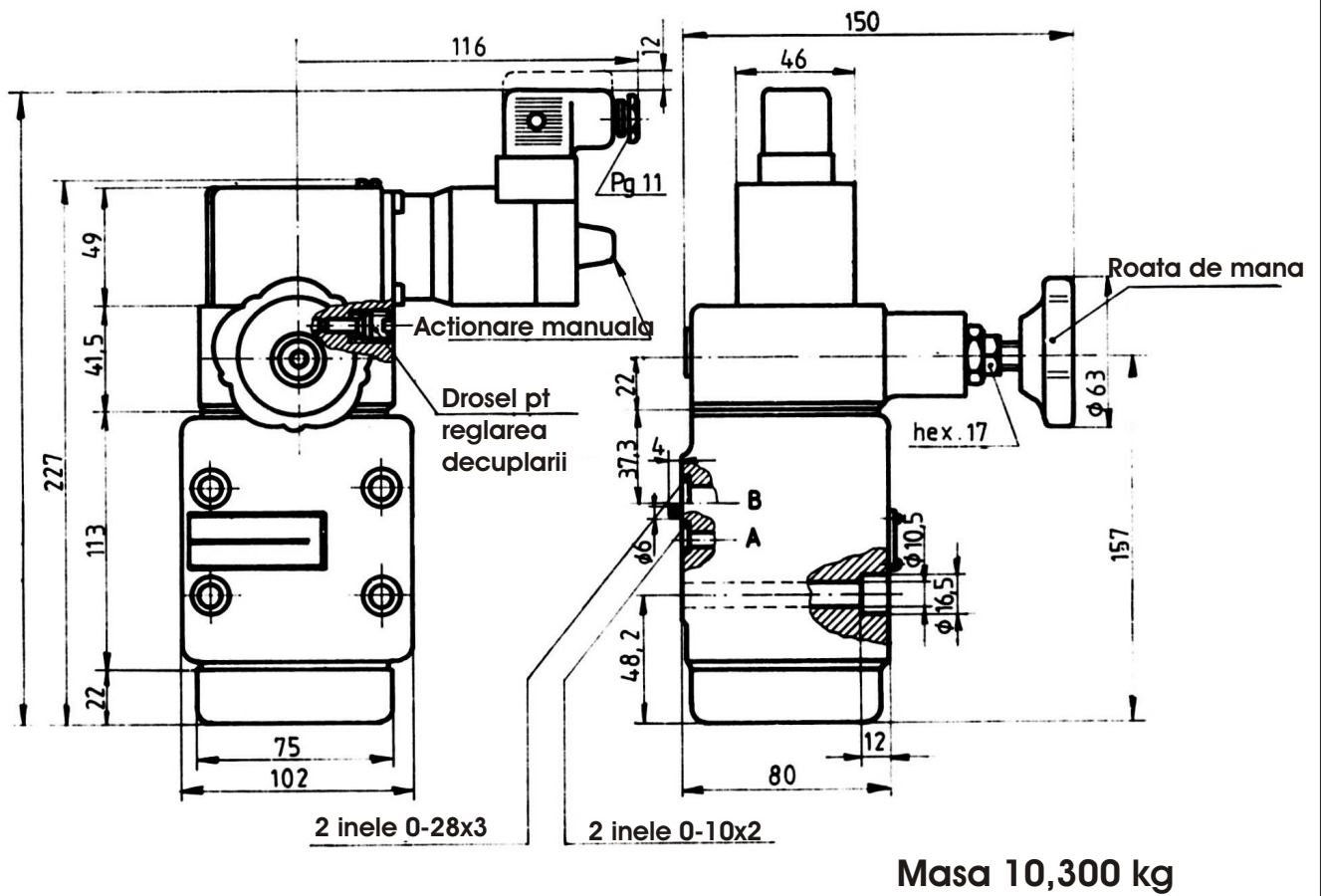

Fig. 33

Supape de presiune Dn32
Schemele 04 ,04U, 06, 16 si 16 U

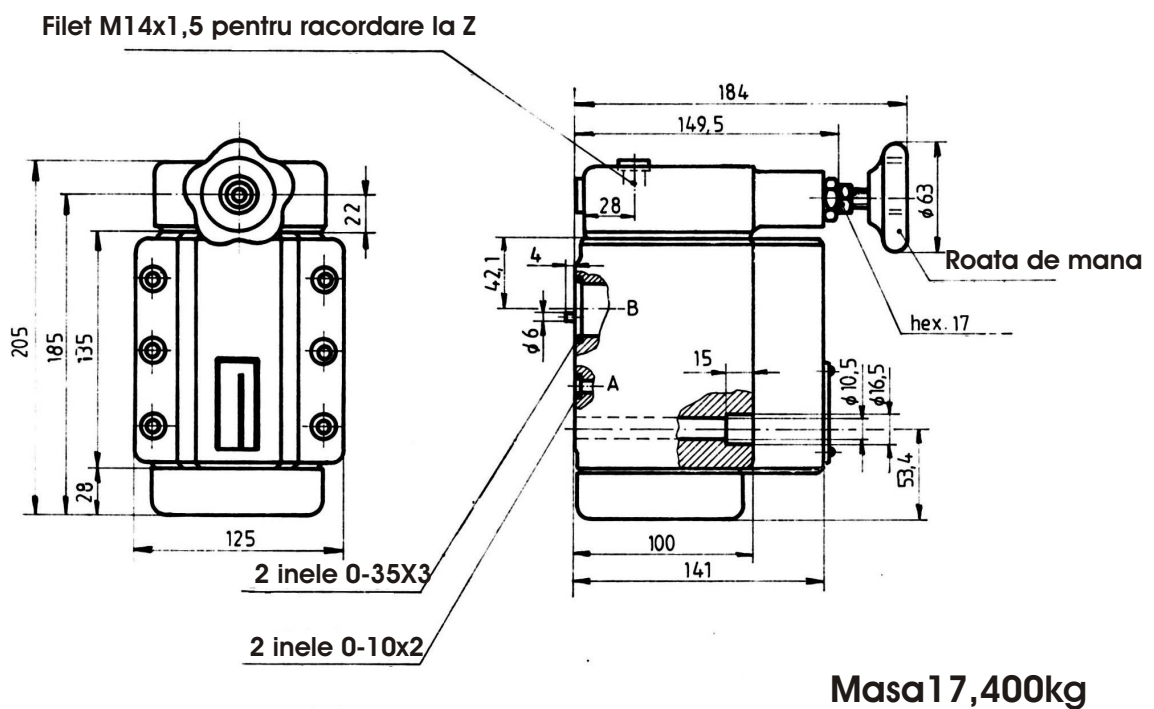

Fig. 34

Schemele 06 ED si 06 EL

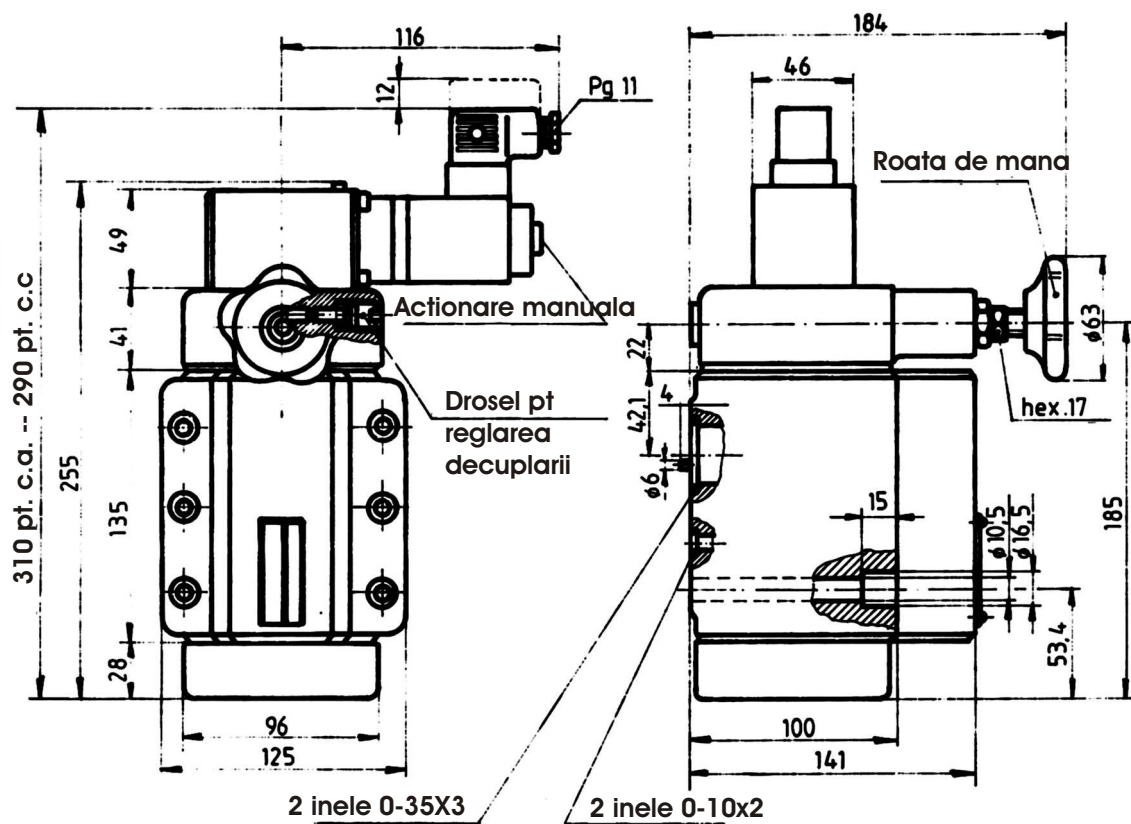

Fig. 35

Masa 19,400kg

PLACI DE BAZA

Supape de presiune Dn10

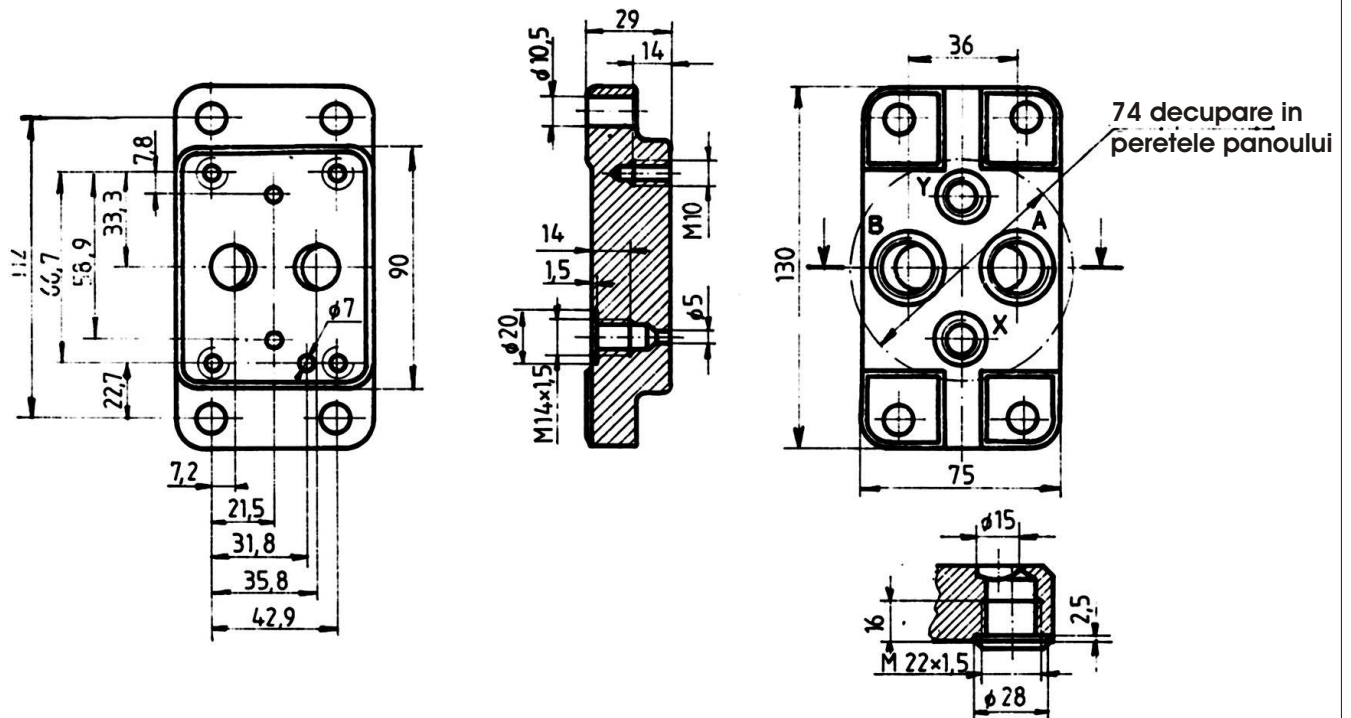

Fig. 36

Supape de presiune Dn20

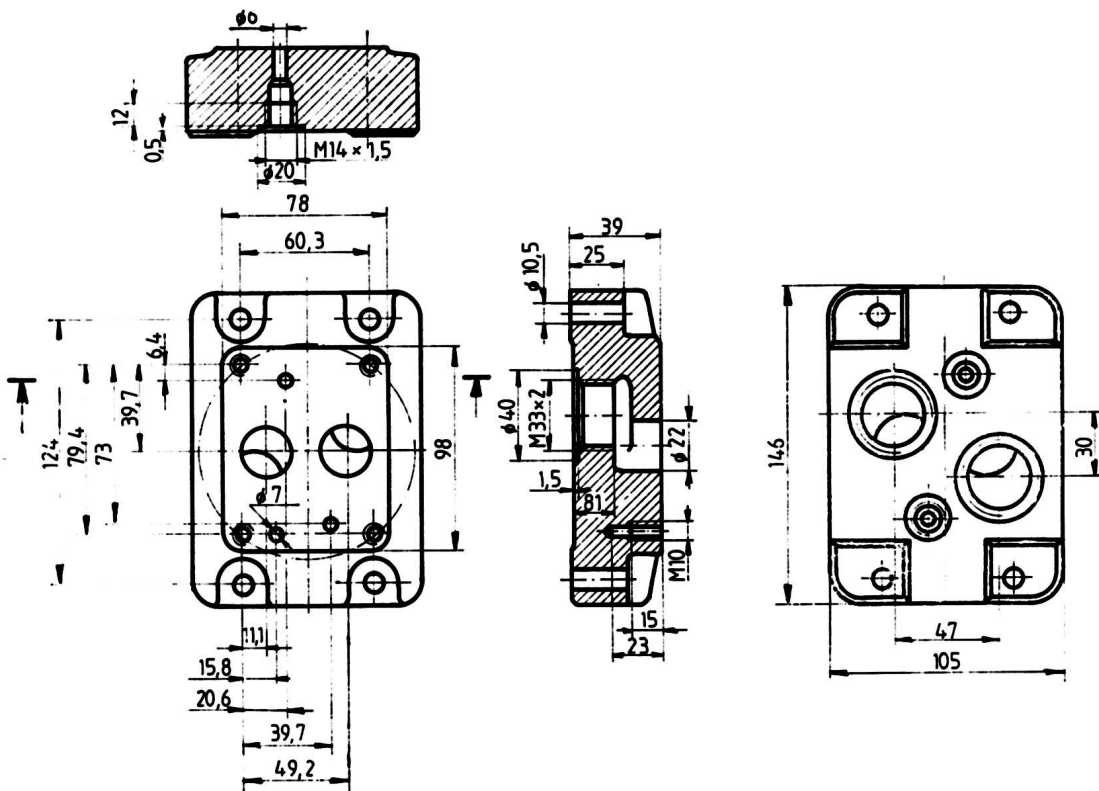

Fig. 37

COD DE COMANDA

1234-5 67-8*/9*-10

*Numai pentru schemele 06 ED si 06 EI

**PREFERENTIALE

1. S-Supapa de presiune
2. P-comanda pilotata
3. P-Montaj pe placa
4. Diametru nominal
5. Schema functionala conform tabel 2
6. Domeniu de reglare
 - 1-7315 bar
 - 2-3160 bar
7. Element de reglare:
 - M-roata de mana
 - G-cap gradat fara asigurare
 - C-cap gradat cu asigurare
- 8/9 Tensiunea electromagnetilor :
 - 012/00-12V
 - 024/00-24V
 - 220/50 -220 V/50 Hz
 - 10 O -Seria de fabricatie .